

## CAT IV AC Voltage Detector + Flashlight

- ✓ Dual range non-contact detection of AC Voltage  
Two selectable ranges for low (down to 24V) and high (up to 1000V)  
non-contact AC Voltage detection

### Features:

- Non-contact detection of AC Voltage in 2 ranges:  
24 to 1000VAC  
100 to 1000VAC
- CAT IV-1000V safety rating
- For use on 50/60Hz circuits
- Rugged double-molded housing
- Tip fits into outlets or against wire insulation testing
- Audible and Visual voltage indication
- Built-in bright flashlight with On/Off button
- Compact size with pocket clip
- Dimensions: 6.25 x 1" (159 x 25mm)  
Weight: 1.48oz (42g)
- Complete with two AAA batteries

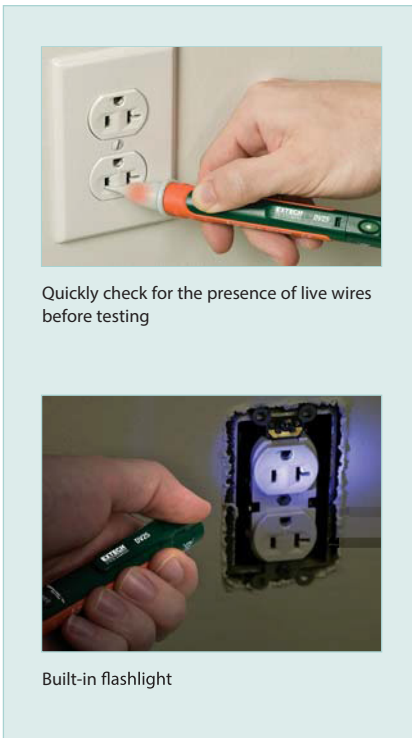

**airconcern**

more info for Extech DV25

Phone: 01235 838 555

E-mail: [cs@airconcern.co.uk](mailto:cs@airconcern.co.uk)

web: [www.airconcern.co.uk](http://www.airconcern.co.uk)